

3D Blade Holder REF 46.007.10



Dear Customer!

We thank you very much for having chosen this high quality instrument from Helmut Zepf. To get the best from your instrument, please follow the instructions below:

DESCRIPTION

1. Pivoted Head
2. Pivoted Head Intake
3. Fixation Screw

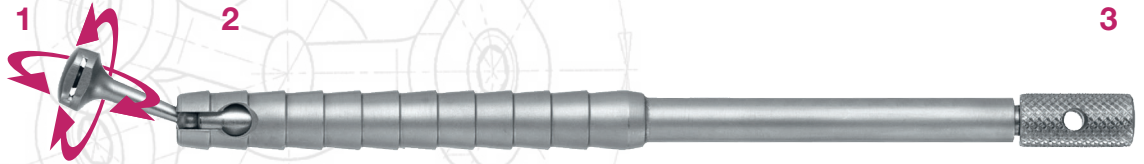

MOUNTING PIVOTED HEAD

1. Open fixation screw, until the pivoted head intake is free
2. Insert the pivoted head joint in the pivoted head intake
3. Set the pivoted head by tightening the fixation screw at the desired position

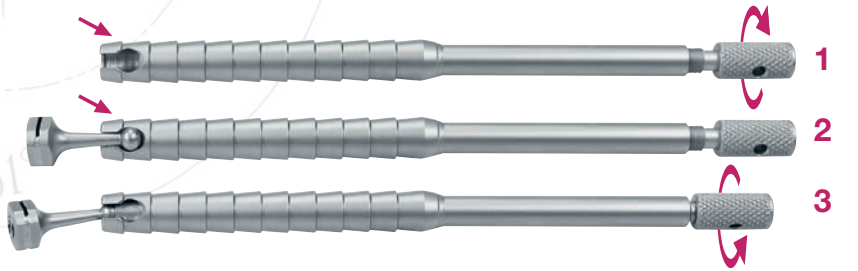

INSERT THE BLADE

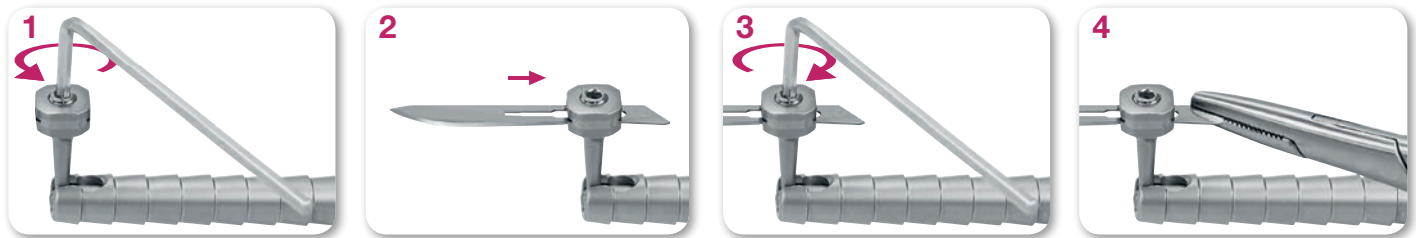

1. Loosening the hexagonal screw with Allen Key 2,5 mm
2. Insert / set blade
3. Fix the blade with Allen Key
4. Break off protruding blade end, e.g. with **41.264.17** Needle Holder Mathieu, straight

ATTENTION: DISMANTLE COMPLETELY FOR CLEANING

Please consider our "Application guidance of autoclavable instruments and accessories according to DIN EN ISO 17664:2004 and MDD 93/42/EWG".



FITTING BLADES

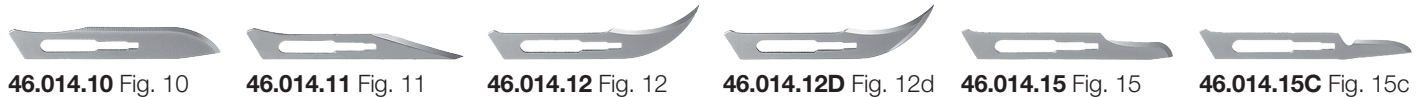

ATTACHMENTS FOR THE 3D-BLADE HOLDER

by Dr. Hildebrand, Berlin

